

## QN Female Bulkhead

### Product Classification

**Product Type** Device connector

### General Specifications

**Interface** QN Female

**Body Style** Bulkhead

### Electrical Specifications

<b>Connector Impedance</b>	50 ohm
<b>Operating Frequency Band</b>	0 – 6000 MHz
<b>RF Operating Voltage, maximum (vrms)</b>	707.00 V
<b>dc Test Voltage</b>	2500 V
<b>Outer Contact Resistance, maximum</b>	1.50 mOhm
<b>Inner Contact Resistance, maximum</b>	1.50 mOhm
<b>Insulation Resistance, minimum</b>	5000 mOhm
<b>Peak Power, maximum</b>	10.00 kW

## Outline Drawing

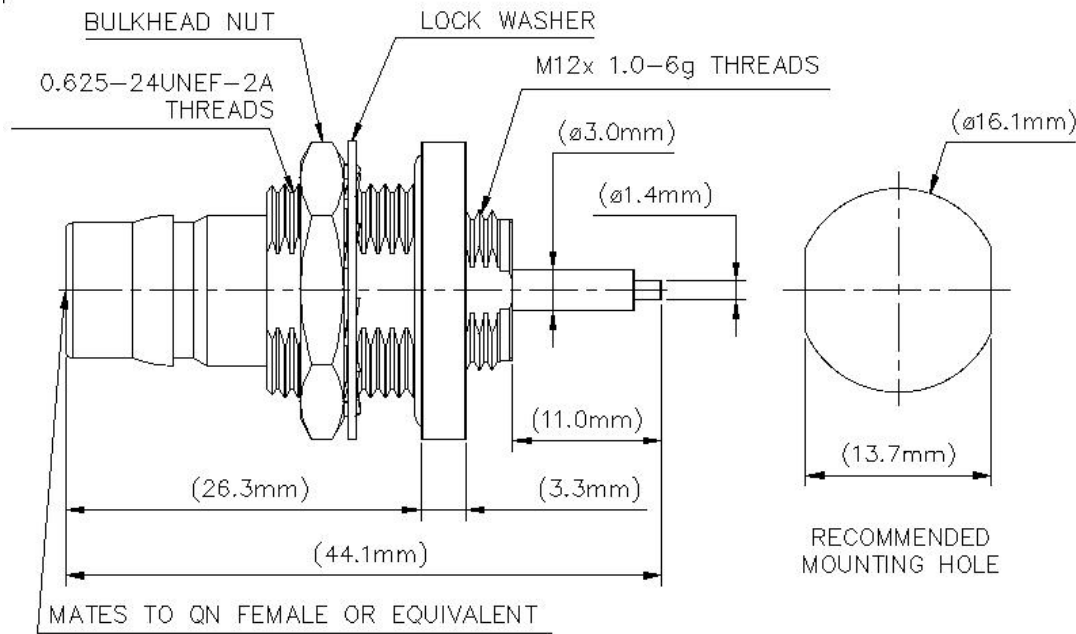

## Mechanical Specifications

<b>Inner Contact Attachment Method</b>	Solder
<b>Inner Contact Plating</b>	Gold
<b>Interface Durability</b>	100 cycles
<b>Interface Durability Method</b>	IEC 61169-16:9.5
<b>Outer Contact Plating</b>	Trimetal

## Dimensions

<b>Diameter</b>	22.10 mm   0.87 in
<b>Length</b>	44.10 mm   1.74 in
<b>Weight</b>	35.20 g   0.08 lb
<b>Width</b>	22.10 mm   0.87 in

## Environmental Specifications

<b>Operating Temperature</b>	-55 °C to +85 °C (-67 °F to +185 °F)
------------------------------	--------------------------------------

<b>Storage Temperature</b>	-65 °C to +125 °C (-85 °F to +257 °F)
<b>Mechanical Shock Test Method</b>	IEC 60068-2-27
<b>Climatic Sequence Test Method</b>	IEC 60068-1
<b>Damp Heat Steady State Test Method</b>	IEC 60068-2-3
<b>Thermal Shock Test Method</b>	IEC 60068-2-14
<b>Vibration Test Method</b>	IEC 60068-2-6
<b>Corrosion Test Method</b>	IEC 60068-2-11

## Standard Conditions

<b>Attenuation, Ambient Temperature</b>	20 °C   68 °F
<b>Average Power, Ambient Temperature</b>	40 °C   104 °F
<b>Average Power, Inner Conductor Temperature</b>	100 °C   212 °F

## Return Loss/VSWR

<b>Frequency Band</b>	<b>VSWR</b>	<b>Return Loss (dB)</b>
0–6000 MHz	1.2	20.83

## Regulatory Compliance/Certifications

### Agency

RoHS 2011/65/EU  
China RoHS SJ/T 11364-2014

### Classification

Compliant by Exemption  
Above Maximum Concentration Value (MCV)

