

Triplex Duct Plugs

PRODUCT COMPONENTS

Refer to [Figure 1](#).

PRODUCT SELECTION

1. Determine the inside diameter of the outer duct, and the outside diameter of the cable or inner duct. Select the correct plug from [Table 1 on Page 2](#).
2. If the diameter of the cable or inner duct is smaller than the specified range, use a bushing sleeve to build up the cable or inner duct diameter. From [Table 1 on Page 2](#), select a plug with a Bushing Sleeve Series number, and refer to the Bushing Sleeve installation instructions, data sheet, or product catalog for a chart that will provide information required to select the correct bushing sleeve.
3. Any unused ports in the plug can be blocked with a Hole Plug. From [Table 1 on Page 2](#), select a plug with a Bushing Sleeve Series number. Refer to the hole plug installation instructions, data sheet, or product catalog for a chart that will provide information required to select the correct hole plug for that bushing sleeve series.

INSTALLATION INSTRUCTIONS

1. Wipe pipe, conduit, or cable clean with cloth. If bushing is needed, split the bushing and place it around pipe, conduit, or cable. (Do not overlap split on bushing.)
2. Loosen nuts to relieve pressure on gasket.
3. Open the plug at the split in the gasket. Wrap the plug around the pipe, conduit, or cable ([Figure](#)).

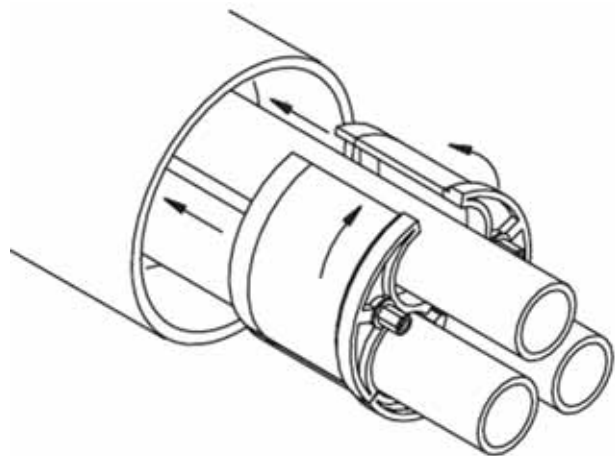

Figure 2

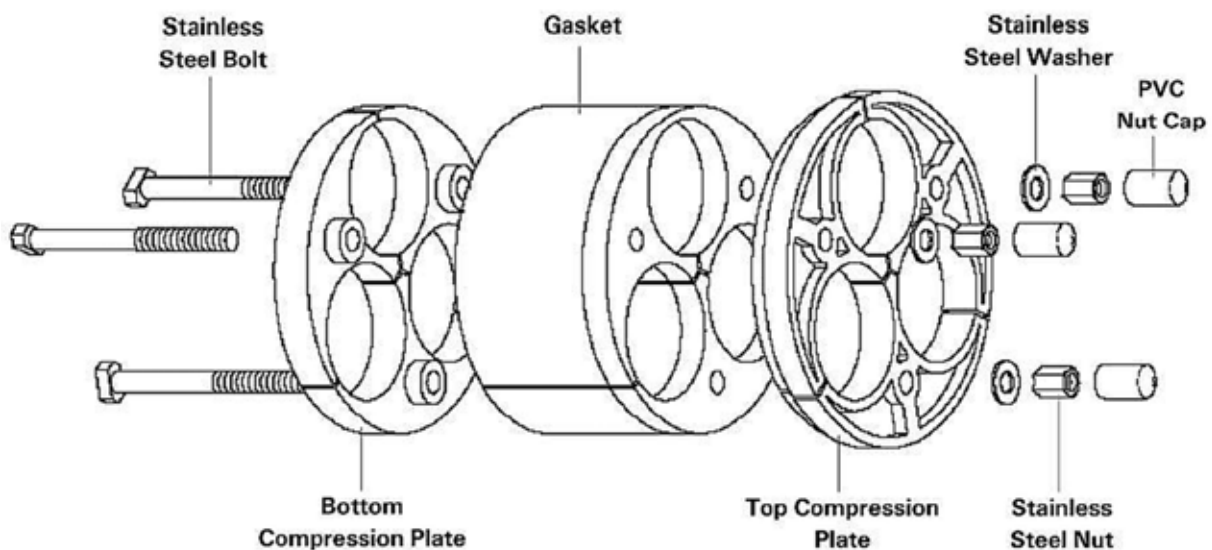

Figure 1

4. Insert the plug into the duct (Figure 3). Tighten the nuts clockwise, evenly, with hand tool. Do not exceed 5-6 ft. lbs. Cover each nut with a PVC nut cap.
5. Installation complete (Figure 4).

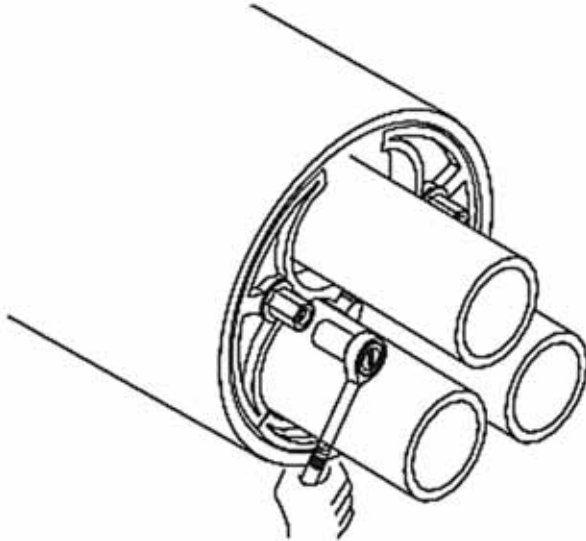

Figure 3

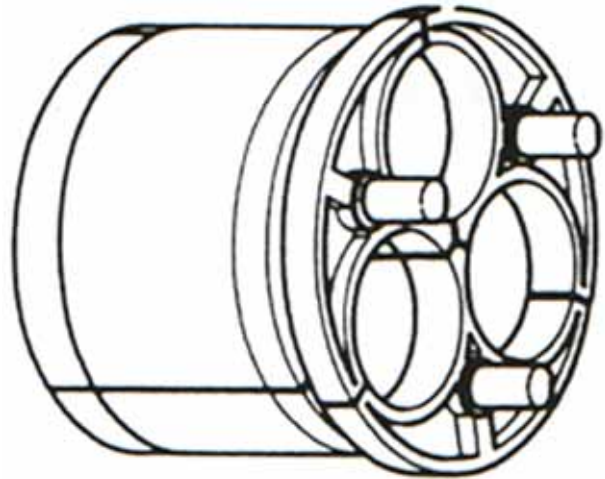

Figure 4

ORDERING INFORMATION

Refer to [Table 1](#). Dimensions are shown in inches and millimeters.

Table 1. Sizes and Specifications

PART NUMBER	PRODUCT DESCRIPTOR*	SIZE	DUCT ID RANGE		CABLE OR DUCT OD RANGE	
			(INCHES)	(MM)	(INCHES)	(MM)
F71967	JM-TRI-21B057SGB	2.00	1.97-2.13	50.0-54.1	0.35-0.57	8.9-14.5
477744	JM-TRI-21B070SGB	2.00	1.97-2.13	50.0-54.1	0.50-0.70	12.7-17.8
742060	JM-TRI-25B057SGB	2.50	2.40-2.56	61.0-65.0	0.35-0.57	8.9-14.5
256254	JM-TRI-25B070SGB	2.50	2.40-2.56	61.0-65.0	0.50-0.70	12.7-17.8
929518	JM-TRI-30B126SGB	3.00	3.03-3.15	77.0-80.0	1.10-1.26	27.9-32.0
610626	JM-TRI-35B126S	3.50	3.49-3.62	88.6-91.9	1.10-1.26	27.9-32.0
436044	JM-TRI-35B136S	3.50	3.49-3.62	88.6-91.9	1.22-1.36	31.0-34.5
A43908	JM-TRI-35B136S-C	3.50	3.49-3.62	88.6-91.9	1.22-1.36	31.0-34.5
894136	JM-TRI-35B142S	3.50	3.49-3.62	88.6-91.9	1.30-1.42	33.0-36.1
804356	JM-TRI-35B155HHG	3.50	3.43-3.54	87.1-89.9	1.38-1.54	35.1-39.1
136838	JM-TRI-36B136SG	3.60	3.70-3.81	94.0-96.8	1.22-1.36	31.0-34.5
004670	JM-TRI-40B122SG	4.00	3.94-4.13	100.1-104.9	1.07-1.22	27.2-31.0
381744	JM-TRI-40B136S	4.00	3.94-4.13	100.1-104.9	1.22-1.36	31.0-34.6
764586	JM-TRI-40B136SG	4.00	3.94-4.13	100.1-104.9	1.22-1.36	31.0-34.6

Table 1. Sizes and Specifications, continued

PART NUMBER	PRODUCT DESCRIPTOR*	SIZE	DUCT ID RANGE		CABLE OR DUCT OD RANGE	
			(INCHES)	(MM)	(INCHES)	
800310	JM-TRI-40B142SG	4.00	3.94-4.13	100.1-104.9	1.30-1.42	33.0-36.1
342658	JM-TRI-40B150SG	4.00	3.94-4.13	100.1-104.9	1.36-1.50	34.5-38.1
A62712	JM-TRI-40B167SG	4.00	4.09-4.29	103.9-109.0	1.63-1.67	38.9-42.4
313092	JM-TRI-40B167S	4.00	4.09-4.29	103.9-109.0	1.63-1.67	38.9-42.4
084348	JM-TRI-40B136AG	4.10	4.16-4.29	105.7-109.0	1.22-1.36	31.0-34.5
342618	JM-TRI-40B136A	4.10	4.16-4.29	105.7-109.0	1.22-1.36	31.0-34.5
887682	JM-TRI-40B142AG	4.10	4.16-4.29	105.7-109.0	1.26-1.42	32.0-36.1
028764	JM-TRI-40B142A	4.10	4.16-4.29	105.7-109.0	1.22-1.42	32.0-36.1
969666	JM-TRI-40B150A	4.10	4.16-4.29	105.7-109.0	1.36-1.50	34.6-38.1
194906	JM-TRI-40B150AG	4.10	4.16-4.29	105.7-109.0	1.36-1.50	34.6-38.1
127328	JM-TRI-40B167A	4.10	4.16-4.29	105.7-109.0	1.53-1.67	38.9-42.4
844602	JM-TRI-42B136SG	4.20	4.48-4.72	113.8-119.9	1.22-1.36	31.0-34.5
978864	JM-TRI-46B167SG	4.60	4.76-4.96	121.0-126.0	1.53-1.67	38.9-42.4
799292	JM-TRI-50B136HG	4.80	4.88-5.10	124.0-129.6	1.22-1.36	31.0-34.5
382176	JM-TRI-50B142HG	4.80	4.88-5.10	124.0-129.6	1.30-1.42	33.0-36.1
313994	JM-TRI-50B192HG	4.80	4.88-5.10	124.0-129.6	1.77-1.92	46.0-48.8
864810	JM-TRI-50B136SG	5.00	5.04-5.35	128.0-135.9	1.18-1.36	30.0-34.5
320024	JM-TRI-50B167SG	5.00	5.04-5.35	128.0-135.9	1.50-1.67	38.1-42.4
E59534	JM-TRI-50B177SG	5.00	5.04-5.35	128.0-135.9	1.64-1.77	41.7-45.0
914454	JM-TRI-50B192SG	5.00	5.04-5.35	128.0-135.9	1.73-1.92	43.9-48.8
300224	JM-TRI-60B136HG	5.80	5.82-5.98	147.8-151.9	1.18-1.36	30.0-34.5
279718	JM-TRI-60B142HG	5.80	5.82-5.98	147.8-151.9	1.30-1.42	33.0-36.1
E08518	JM-TRI-60B177HG	5.80	5.82-5.98	147.8-151.9	1.64-1.77	41.7-45.0
961652	JM-TRI-60B192HG	5.80	5.82-5.98	147.8-151.9	1.81-1.92	46.0-48.8
C28385	JM-TRI-60B196HG	5.80	5.82-5.98	147.8-151.9	1.84-1.96	46.7-49.8
181018	JM-TRI-60B204HG	5.80	5.82-5.98	147.8-151.9	1.92-2.04	48.8-51.8
727930	JM-TRI-60B220HG	5.80	5.82-5.98	147.8-151.9	2.08-2.20	52.8-55.9
C27651	JM-TRI-60B236HGB	5.80	5.82-5.98	147.8-151.9	1.96-2.36	49.8-59.9
724984	JM-TRI-60B136SG	6.00	6.00-6.22	152.4-158.0	1.18-1.36	30.0-34.5
177006	JM-TRI-60B142SG	6.00	6.00-6.22	152.4-158.0	1.26-1.42	32.0-36.1
662416	JM-TRI-60B167SG	6.00	6.00-6.22	152.4-158.0	1.50-1.67	38.1-36.1
E16791	JM-TRI-60B177SG	6.00	6.00-6.22	152.4-158.0	1.64-1.77	41.7-45.0
110988	JM-TRI-60B192SG	6.00	6.00-6.22	152.4-158.0	1.73-1.92	43.9-48.8
D68827	JM-TRI-60B196SG	6.00	6.00-6.22	152.4-158.0	1.84-1.96	46.7-49.8
950944	JM-TRI-60B204SG	6.00	6.00-6.22	152.4-158.0	1.92-2.04	48.8-51.8
412656	JM-TRI-60B217SG	6.00	6.00-6.22	152.4-158.0	2.05-2.17	52.1-55.1
489480	JM-TRI-60B220SG	6.00	6.00-6.22	152.4-158.0	2.08-2.20	52.8-55.9

Table 1. Sizes and Specifications, continued

PART NUMBER	PRODUCT DESCRIPTOR*	SIZE	DUCT ID RANGE		CABLE OR DUCT OD RANGE	
			(INCHES)	(MM)	(INCHES)	
149562	JM-TRI-60B236SGB	6.00	6.00-6.22	152.4-158.0	1.92-2.32	48.8-58.9
202290	JM-TRI-60B255SG	6.00	6.00-6.22	152.4-158.0	2.45-2.55	62.2-64.8
795634	JM-TRI-100B346HG	10.00	8.70-8.90	221.0-226.1	3.23-3.39	82.0-86.1
515168	JM-TRI-100B192S	10.00	9.96-10.25	253.0-260.4	1.81-1.92	46.0-48.8
960076	JM-TRI-120B396HG	12.00	10.35-10.55	262.9-268.0	3.74-3.90	95.0-99.1
982534	JM-TRI-30B090SGB-2	3.00	3.03-3.15	77.0-80.0	(2x)0.65-0.90 (1x)0.57-0.70	16.5-22.9 14.5-17.8
125962	JM-TRI-30B132S-1	3.00	3.03-3.15	77.0-80.0	(2x)1.18-1.30 (1x)0.79-0.87	30.0-33.0 20.1-22.1
163986	JM-TRI-31T126SB	3.10	3.10-3.30	77.0-80.0	1.10-1.26	27.9-32.0
455984	JM-TRI-35B118HG-2	3.50	3.49-3.62	88.6-91.9	(2x)1.42-1.55 (1x)1.02-1.15	36.1-39.4 25.9-29.2
849012	JM-TRI-35B155HG-2	3.50	3.49-3.62	88.6-91.9	(2x)1.42-1.55 (1x)1.02-1.15	36.1-39.4 25.9-29.2
A32730	JM-TRI-38T126SGB	3.80	3.78-4.09	96.0-103.9	1.18-1.26	30.0-32.0
642858	JM-TRI-40T142S	4.00	3.92-4.05	99.6-102.9	1.31-1.42	33.3-36.1
142784	JM-TRI-40T167SGB-H	4.00	4.09-4.29	103.9-109.0	1.64-1.67	39.1-42.4
101256	JM-TRI-40B179SG1	4.00	3.94-4.13	100.1-104.9	1.57-1.67	40.0-42.4
008098	JM-TRI-40B190SHG-2	4.00	4.02-4.16	102.1-105.7	(2x)1.57-1.67 (1x)1.81-1.91	40.0-42.4 46.0-48.5
914454	JM-TRI-50B260SG-1	5.00	5.04-5.35	128.0-135.9	(2x)2.40-2.56 (1x)0.47-0.55	61.0-65.0 11.9-14.0

***Suffix Descriptor:** S = standard PVC and PE ducts (ID); A= oversize duct (ID); H = undersize ducts (ID); HH = undersize ducts and overlap gasket; B = duct plugs with inner bushing; G = duct plugs with coated metal compression plates; # = ports with different ID; H = hold plug included.



TECHNICAL SUPPORT OR PRODUCT INFORMATION

<http://www.commscope.com/SupportCenter/TechnicalSupport.aspx>