

REVISIONS				
REV	LTN	DESCRIPTION	DATE	APVD
C	ECR-13-000687		14 JAN 2013	HB DT
C1		Position of the label added	04 MAR 2013	WDV HB
D	ECN 8000018048	REBRANDING	21 DEC 2016	RER SC

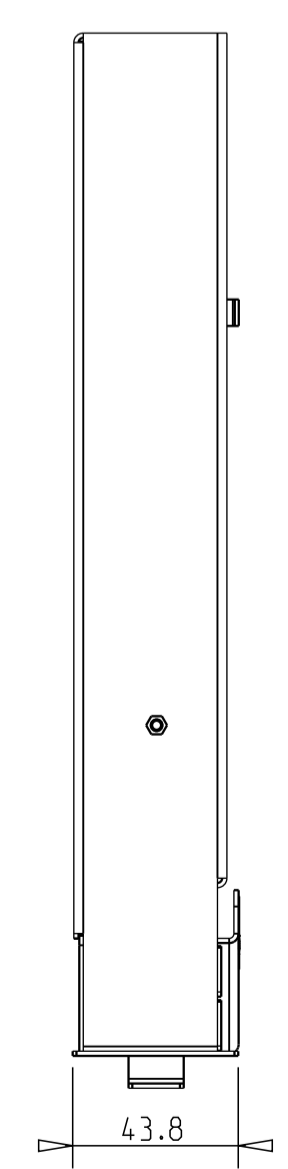
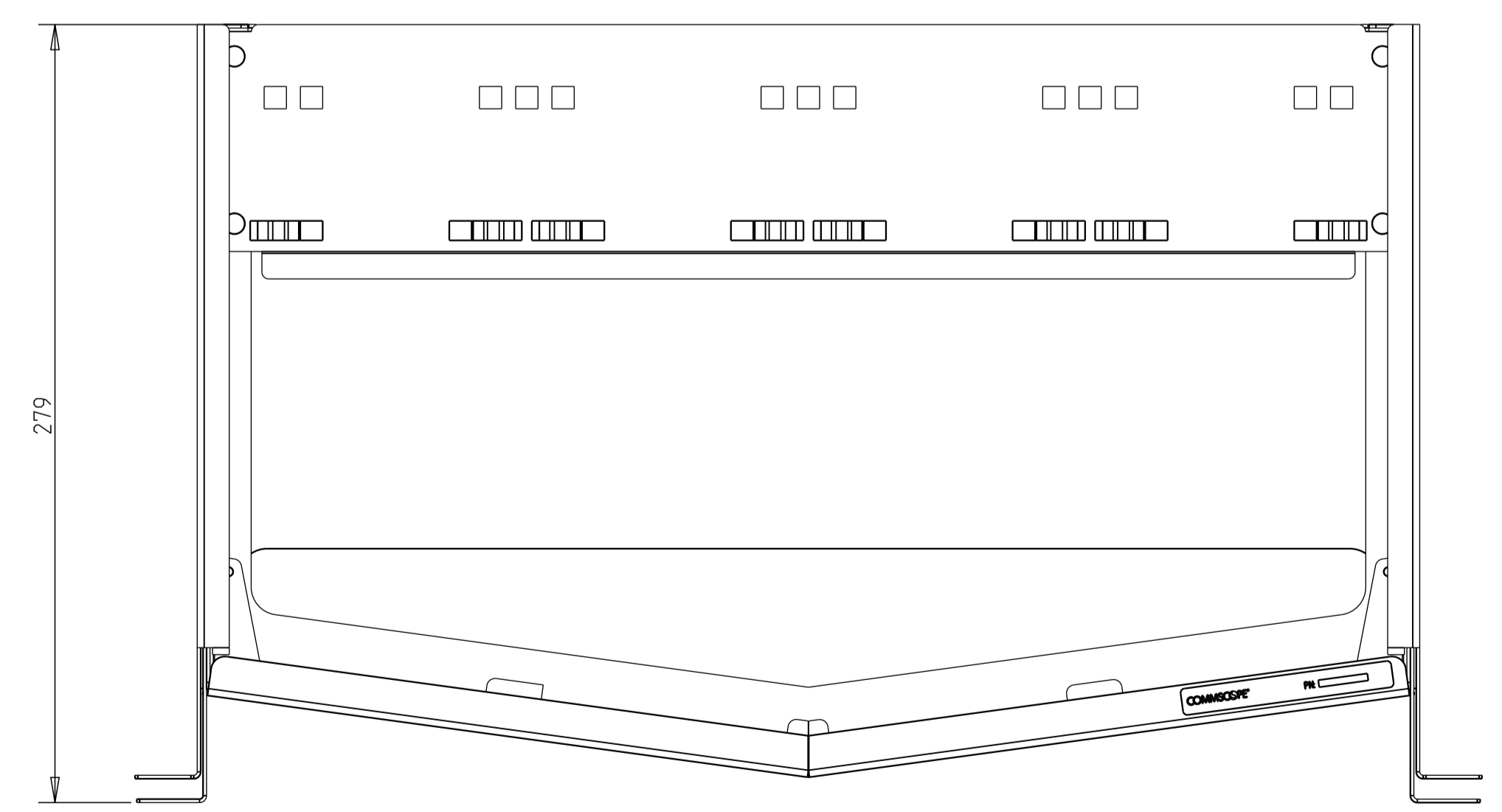
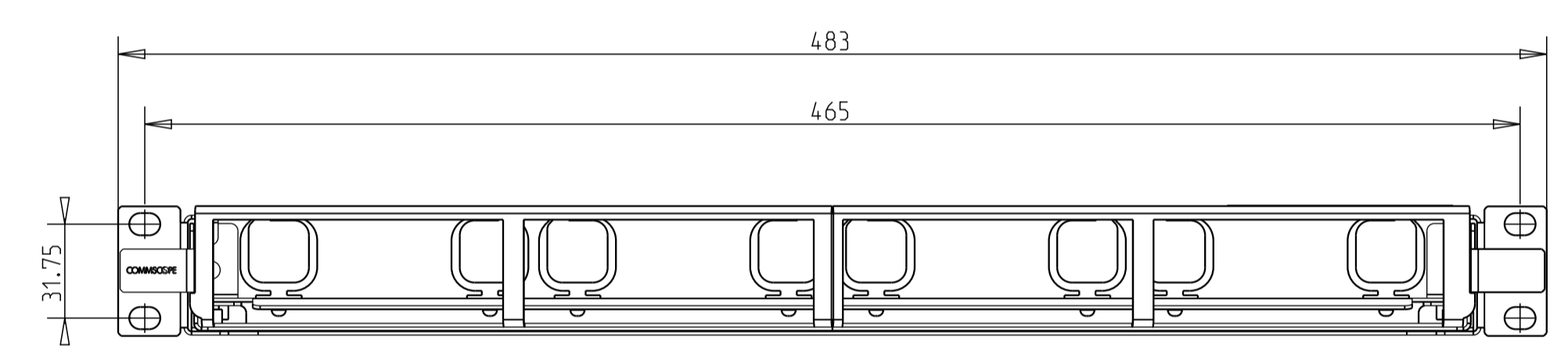
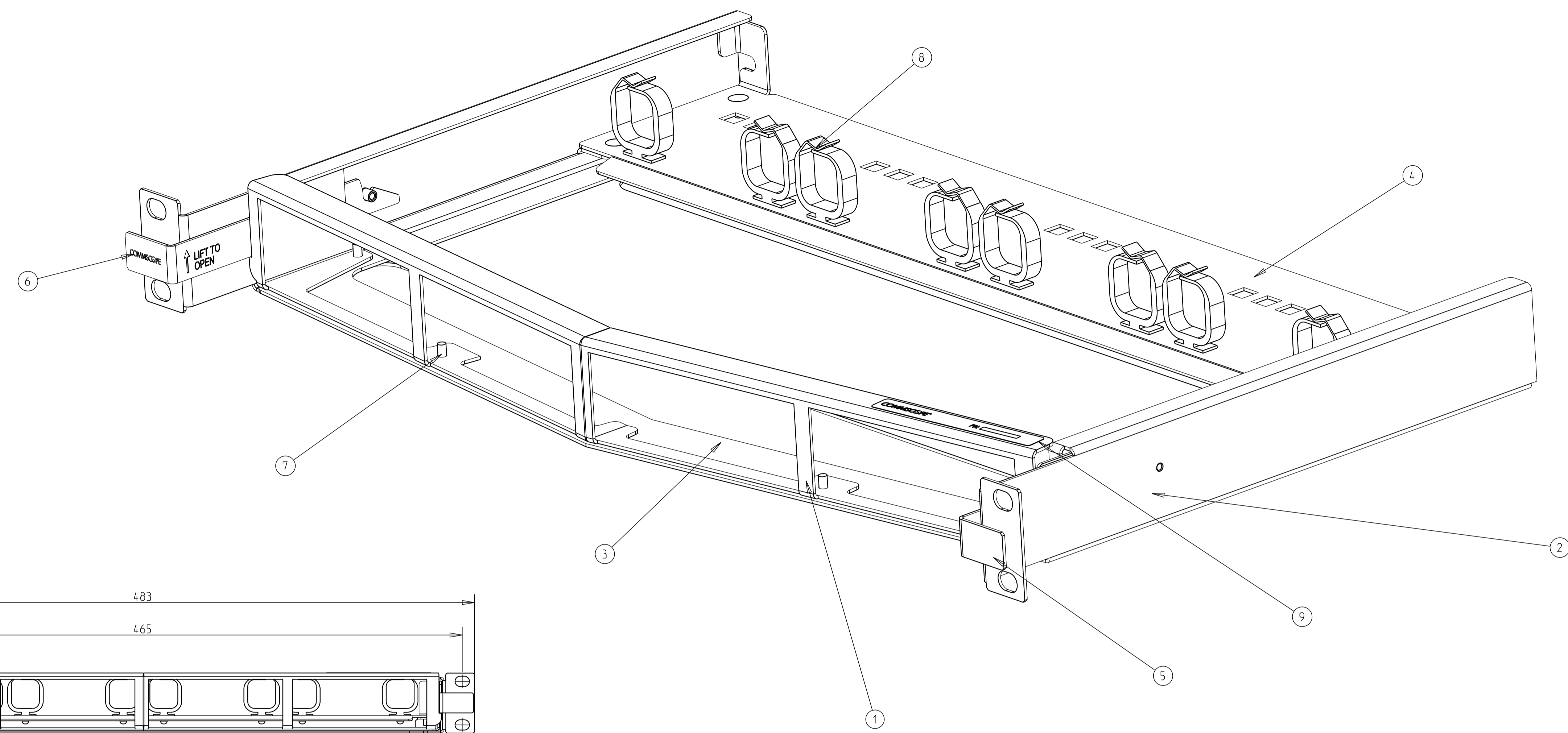

OFN Saddles are shown in the suggested position. These are included, not mounted!

QTY	DESCRIPTION	ITEM
1	Label	9
8	OFN Saddle	8
10	Countersunk Rivet 3.2 x 6.5-7.5 AL	7
1	MOD FO Panel Lock Left	6
1	MOD FO Panel Lock Right	5
1	Q-F MPO Panel Cable Mgmt Bar	4
1	AMP Hi-D Q-F MPO Panel Tray	3
1	AMP Hi-D Q-F MPO Panel Base	2
1	AMP Hi-D Q-F MPO Panel Frontplate	1

SCALE 0.500

THIS DRAWING IS A CONTROLLED DOCUMENT.		OWN	W. DE VIS	26APR2010
		CHK	H. BLEUS	26APR2010
		APVD	D. THUIS	26APR2010
DIMENSIONS:		NAME		
mm		AMP Hi-D Modular Quick-Fit MPO Sliding Panel		
TOLERANCES UNLESS OTHERWISE SPECIFIED:		PRODUCT SPEC		
0 PLC		-		
1 PLC		-		
2 PLC		-		
3 PLC		-		
4 PLC		-		
ANGLES		APPLICATION SPEC		
-		-		
FINISH		MATERIAL		
-		-		
		SIZE		RESTRICTED TO
		A 1		-
		CAGE CODE		SCALE
		C=1671436-C		1.000
		DRAWING NO		SHEET
		-		1 of 1
		CUSTOMER DRAWING		REV
				D