

THIS DRAWING IS UNPUBLISHED.

RELEASED FOR PUBLICATION

© 2016 COMMSCOPE, INC. CONFIDENTIAL

NOTICE: THESE DRAWINGS AND SPECIFICATIONS ARE THE PROPRIETARY PROPERTY OF COMMSCOPE, INC. AND MAY BE USED ONLY FOR THE SPECIFIC PURPOSE AUTHORIZED IN WRITING BY COMMSCOPE, INC.

REVISIONS

P	LTR	DESCRIPTION	DATE	DWN	APVD
	C	DWG UPDATED REMOVED TABLE / ECR-10-001399	20-Jan-10	JG	JS
	D	REV PER BNS_CD_BRAND	02FEB2017	GG	DC

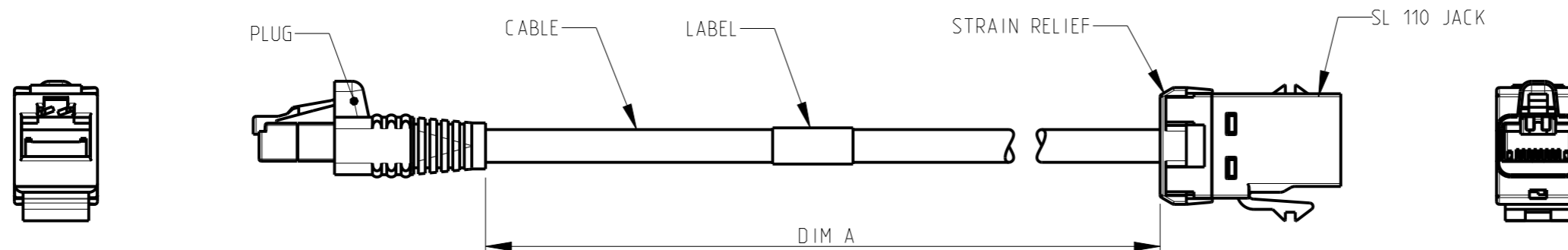

VIEW SCHEMATIC

1. Class E CONSOLIDATION POINT CABLE ASSEMBLIES ARE USED TO EXTEND THE HORIZONTAL CABLING FROM THE CONSOLIDATION OR TRANSITION POINT TO THE TELECOMMUNICATIONS OUTLET, ACCORDING TO ISO/IEC 11801.
2. FOR AVAILABLE DASH LENGTHS, DIM A, SEE THE TYCO ELECTRONICS CATALOGUE OR CONTACT YOUR SALES REPRESENTATIVE.

THIS DRAWING IS A CONTROLLED DOCUMENT.

DIMENSIONS:  
mm

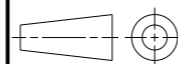

MATERIAL -

TOLERANCES UNLESS OTHERWISE SPECIFIED:

0 PLC	±
1 PLC	±
2 PLC	±
3 PLC	±
4 PLC	±
ANGLES	±

FINISH -

DWN J.GATNAU 03-Aug-09

CHK M.MAQUEDA 03-Aug-09

APVD J.SANABRA 03-Aug-09

PRODUCT SPEC  
108-93041

APPLICATION SPEC

WEIGHT -

CUSTOMER DRAWING

COMMSCOPE, INC.

NAME  
CONS. POINT RJ45 W/O DUST COVER  
Class E  
UTP LSZH SOLID WHITE

SIZE CAGE CODE DRAWING NO RESTRICTED TO

A3 - C-1711027

SCALE 1:1 SHEET 1 OF 1 REV D