

REV	REV	MO	CO	DWN	DATE
	D	20	24	JM	21-AUG-08
	F	20	25	-JM	DB-08M-08

NOTES:

1.0 SCOPE

THIS SPECIFICATION DEFINES THE REQUIREMENTS FOR A ASSY 6-PORT, ALL FIT MULTIMEDIA COLOR XX

2.0 APPLICABLE DOCUMENTS

- 2.1 UL 94 "TESTS FOR FLAMMABILITY OF PLASTIC MATERIALS"
- 2.2 ORDER OF PRECEDENCE

IN CASE OF CONFLICT, THE FOLLOWING ORDER OF PRECEDENCE SHALL APPLY:  
 A. PURCHASE ORDER  
 B. THIS DOCUMENT

3.0 REQUIREMENTS

- 3.1 MATERIALS
  - 3.1.1 MATERIAL: SEE TAB.
  - 3.1.2 COLOR: SEE TAB
- 3.2 DIMENSIONAL
  - 3.2.1 SEE DRAWING
  - 3.2.2 PART TO BE FREE OF BURRS, SCRATCHES, SPOTS AND NOTICEABLE SINK.
- 3.3 FLAMMABILITY:
  - 3.3.1 FLAMMABILITY RATING: MATERIAL USED SHALL BE UL94 V-0 LISTED.
- 3.4 MARKING AND MOLDING:
  - 3.4.1 CLASSIFIED U.S. UL LOGO, CLASSIFIED CANADA UL LOGO, UP ARROW DIRECTION, CATALOG NUMBER AND ADC LOGO, SHOULD BE MOLDED INSIDE THE FACE PLATE.

4.0 QUALITY ASSURANCE PROVISIONS:

- 4.1 MANUFACTURING INSPECTION:  
 THE MANUFACTURER SHALL PREFORM AUDITS TO ENSURE 100% FUNCTIONALITY OF ALL RECEIVED PARTS. ADDITIONAL TESTING AND INSPECTIONS SHALL BE PREFORMED AS NEEDED TO ENSURE THAT ALL REQUIREMENTS ARE MET.
- 4.2 QUALITY CONFORMANCE INSPECTION  
 BUYER RESERVES THE RIGHT TO RETURN AT THE MANUFACTURER'S EXPENSE ANY NONCONFORMING MATERIALS OR LOTS WHICH DO NOT MEET SAMPLING INSPECTION REQUIREMENTS.
- 4.3 DESIGN AND PROCESS CHANGE:  
 NO CHANGES IN MATERIAL DESIGN OR PROCESS WHICH WILL AFFECT FORM, FIT OR FUNCTION SHALL BE MADE BY THE MANUFACTURER AFTER SAMPLE APPROVAL WITHOUT WRITTEN AUTHORITY FORM THE BUYER. THE TERM "FUNCTIONAL" IMPLIES SECTION 3.0 PARAMETERS.

5.0 PACKAGING AND HANDLING REQUIREMENTS:

- 5.1 MAXIMUM CONTAINER WEIGHT: 40 LBS.
- 5.2 SHIPPING CONTAINER MARKING(S)

SHIPPING CONTAINERS SHALL BE MARKED WITH THE FOLLOWING AS A MINIMUM:

1. MANUFACTURER'S NAME AND/OR LOGO
2. ADC PART NUMBER
3. ADC PURCHASE ORDER NUMBER
4. QUANTITY ENCLOSED
5. (PREFERRED BUT OPTIONAL INFORMATION):  
 NUMBER OF SEPARATE PACKAGES/BOXES  
 ("BOX# \_\_\_\_\_ OF \_\_\_\_\_ BOXES")

COMMSCOPE, INC.

<small>© 2016 COMMSCOPE, INC. CONFIDENTIAL          NOTICE: THESE DRAWINGS AND SPECIFICATIONS ARE THE PROPRIETARY PROPERTY OF COMMSCOPE, INC. AND MAY BE USED ONLY FOR THE SPECIFIC PURPOSE AUTHORIZED IN WRITING BY COMMSCOPE, INC.</small>		TITLE ASSY, 6-PORT, ALL FIT MULTIMEDIA COLOR XX	
<small>ALL DIMS AND TOLERANCES .XX:±          ARE INCHES UNLESS .XXX:±          OTHERWISE SPECIFIED ANGULAR:±</small>	C SIZE	DRAWING NUMBER 66442202XX_ADC	F REV
DO NOT SCALE DRAWING	ENGR: LUIS SANCHEZ DWN: JUAN MONCADA	SHT. 1 OF 2	

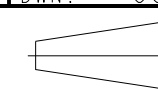
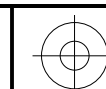

DIMENSIONS IN INCHES  
 THIRD ANGLE PROJECTION

A

B

C

D

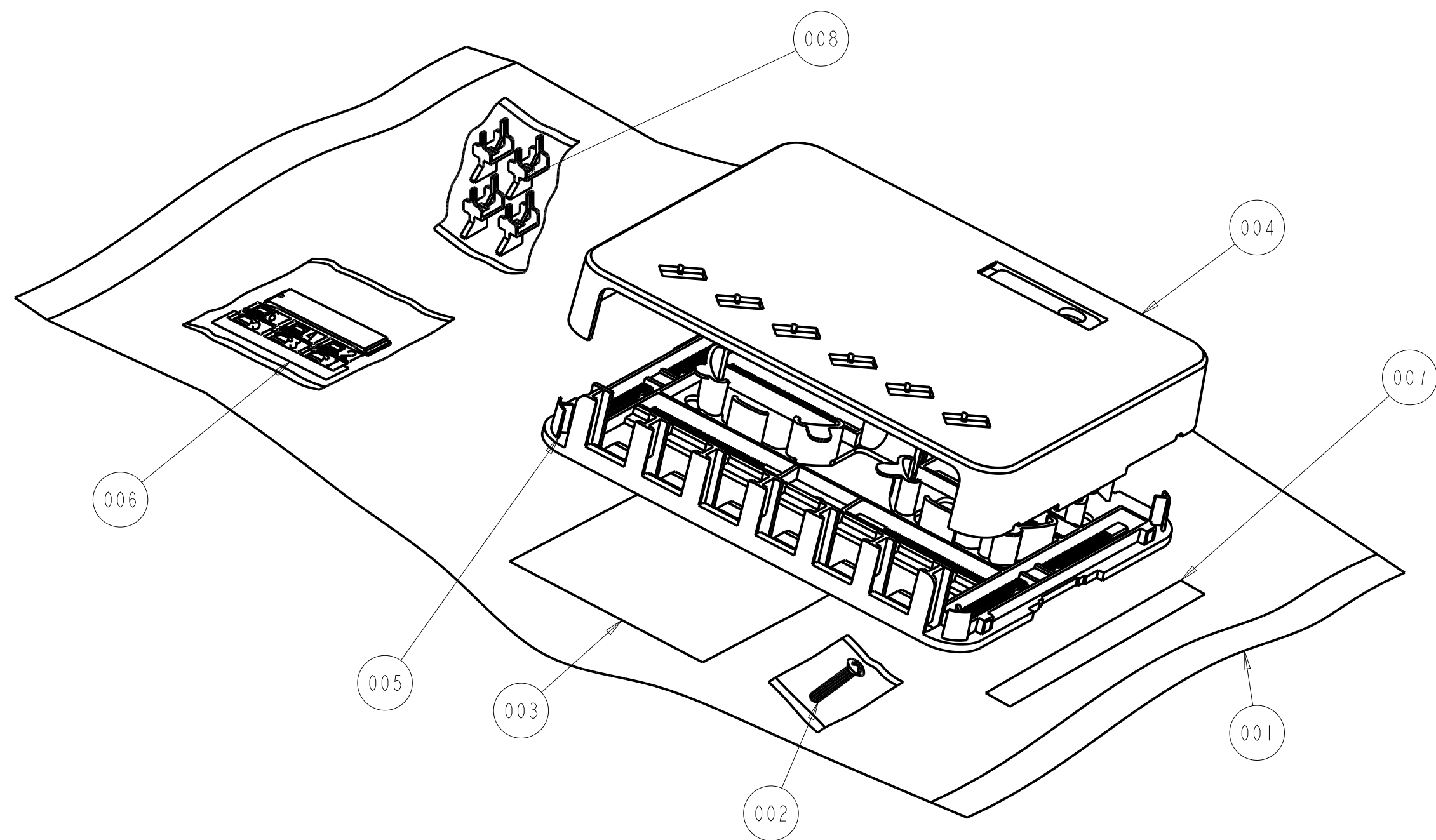

ADC P/N	CATALOG	REV	COMPONENT F/N 002 POLYBAG W/ SCREW #6X1/2 QTY 1	COMPONENT F/N 003 INST SHEET ALL FIT (COLOR) QTY 1	COMPONENT F/N 004 COVER ALL FIT (COLOR) QTY 1	COMPONENT F/N 005 BASE ALL FIT COLOR QTY (1)	COMPONENT F/N 006 POLY BAG ID TABS QTY (1)	COMPONENT F/N 007 VELCRO STRIP QTY (1)	COMPONENT F/N 008 SLIDING RETENTION DEVICE QTY (1)	PANTONE COLOR	FEDERAL STANDAR SPECIFICATION
6644220201	6644 2 202-01	E	6630 3 100-68	1453700	6644 3 115-01 (WHITE)	6644 3 114-01 (WHITE)	6630 2 104-01 (WHITE)	6639 3 030-04	6630 3 104-04	---	FED STD. 37925
6644220202	6644 2 202-02	E			6644 3 115-02 (IVORY)	6644 3 114-02 (IVORY)	6630 2 104-02 (IVORY)			---	FED STD. 27886
6644220203	6644 2 202-03	E			6644 3 115-03 (GREY)	6644 3 114-03 (GREY)	6630 2 104-03 (GREY)			421C	FED STD. 25630
6644220204	6644 2 202-04	E			6644 3 115-04 (BLACK)	6644 3 114-04 (BLACK)	6630 2 104-04 (BLACK)			6C2X	FED STD 27038

COMMSCOPE, INC.

© 2016 COMMSCOPE, INC. CONFIDENTIAL  
 NOTICE: THESE DRAWINGS AND SPECIFICATIONS  
 ARE THE PROPRIETARY PROPERTY OF  
 COMMSCOPE, INC. AND MAY BE USED ONLY FOR THE  
 SPECIFIC PURPOSE AUTHORIZED IN WRITING BY  
 COMMSCOPE, INC.

TITLE ASSY,  
 6-PORT, ALL FIT  
 MULTIMEDIA COLOR XX

ALL DIMS AND TOLERANCES .XX:±  
 ARE INCHES UNLESS .XXX:±  
 OTHERWISE SPECIFIED ANGULAR:±

DO NOT SCALE DRAWING

ENGR: LUIS SANCHEZ  
 DWN: JUAN MONCADA

DRAWING NUMBER  
 66442202XX\_ADC

SHT. 2 OF 2

DIMENSIONS IN INCHES  
 THIRD ANGLE PROJECTION