

Installation Instructions

Connector Attachment

For Braided Cable CNT-195

TNC Male, Solder Pin, Clamp-type Body: 195PTM

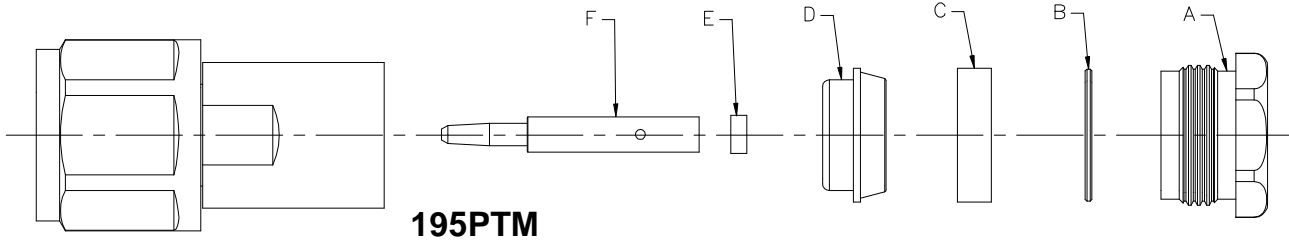

195PTM

<p>1 Remove 5.5 mm (0.217") of Jacket only.</p>	<p>2 Slide parts A, B, C onto the cable. Note: the direction of part C as shown.</p>	<p>3 Comb braid straight with a wire brush.</p>
<p>4 Install part D as shown without damaging the braid.</p>	<p>5 Fold braid around part D and comb braid as shown, the braid should be straight and equally spaced after comb.</p>	<p>6 Cut off the redundant braid as shown.</p>
<p>7 Remove 4.0 mm (0.157") of foam. Remove all foam/glue residue from the center conductor.</p>	<p>8 Chamfer the center conductor at a 45° angle.</p>	<p>9 Push parts E & F onto the cable center conductor.</p>
<p>10 Solder part F & cable center conductor together. Inspect soldering point, solder should fill cup but not spill over.</p>	<p>11 The cable attachment must be straight and aligned with the hole of connector insulator. Insert the cable attachment into the connector body until stopped; the part F must be inserted into the hole of connector insulator. Tighten the connection to the torque value of 60-80 lb-in (6.8-9.0 Nm). Note: Do not turn connector body, turn cable attachment. The V type part C are splitted into two pieces after part A installation.</p>	



	表一 有毒有害物质或元素名称及含量标识格式					
	有毒有害物质或元素					
部件名称 (Part Name)	铅 (Pb)	汞 (Hg)	镉 (Cd)	六价铬 (Cr6+)	多溴联苯 (PBB)	多溴二苯醚 (PBDE)
连接器 (Connector)	X	O	O	O	O	O

O: 表示有毒有害物质在该部件所有的均质材料中的含量均在SJ/T 11363-2006规定的限量要求以下.
X: 表示该有毒有害物质至少在该部件的某一均质材料中的含量超出SJ/T 11363-2006规定的限量要求.



ANDREW[®]

Notice: Andrew disclaims any liability or responsibility for the results of improper or unsafe installation, in spection, maintenance, or removal practices

Installation Training Available at Andrew Institute

Andrew Corporation

3 Westbrook Corporate Center, Suite 900, Westchester, Illinois U.S.A. 60154

+1 (779) 435-8579 Fax (U.S.A.): 1-800-349-5444

www.andrew.com

Copyright © 2008 by Andrew Corporation

Customer Service, 24 hours

U.S.A., Canada, Mexico: 1-800-255-1479

U.K.: 0800 250055

Other Europe: +44 592 782 612

China: +86 512-6256-8805