

H090MC091C091SG

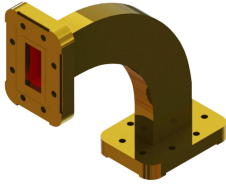

90° H Plane Swept Bend for WR90, 8.2–12.4 GHz, with interface types CPR90G and CPR90G, 91 mm x 91 mm, gray

Product Classification

Product Type Rectangular waveguide, swept bend

General Specifications

Component 90° H Plane Swept Bend

Interface CPR90G

Interface 2 CPR90G

Dimensions

Length 91 mm | 3.583 in

Length 2 91 mm | 3.583 in

Waveguide Size WR90 | WG16 | R100

Electrical Specifications

Operating Frequency Band 8.2 – 12.4 GHz

VSWR 1.05

Material Specifications

Finish Gray

Regulatory Compliance/Certifications

Agency	Classification
ISO 9001:2015	Designed, manufactured and/or distributed under this quality management system